

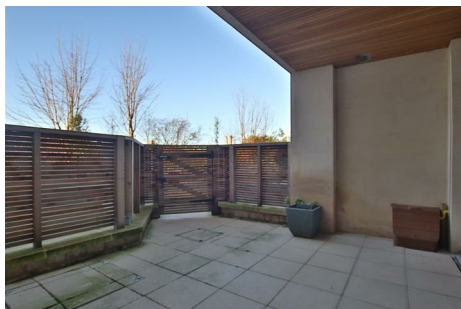

# ASPIRE

— TO MOVE —



## Hope Place, Lansdown Road, Bath, BA1

Video and physical viewings available. Spacious and well equipped one bedroom apartment with courtyard, located in the popular new, Hope Place development in Bath. Available unfurnished, from the 18th July.

The apartment is located in the Hope Place development, set back from Lansdown Road in Bath. Within the development there is access to bin stores and a bike store. There is a bus stop on Lansdown Road and there is a local convenience store 0.2 miles away.

**£1,495 PCM**

# Hope Place, Lansdown Road, Bath, BA1

- Spacious and well equipped one bedroom apartment
- Bike and bin store
- Private woodland areas within development
- Video tour available
- Courtyard garden
- Available 18th July
- Close to city centre
- Holding deposit: £345
- Use of Residents Tennis Court
- Council tax band D

Video and physical viewings available. Spacious and well equipped one bedroom apartment with courtyard, located in the popular new, Hope Place development in Bath. Available unfurnished, from the 18th July.

The apartment is located in the Hope Place development, set back from Lansdown Road in Bath. Within the development there is access to bin stores and a bike store. There is a bus stop on Lansdown Road and there is a local convenience store 0.2 miles away.

The entrance hallway is spacious and has a storage cupboard. There is an open-plan kitchen/living/dining room. The kitchen has base and wall units and granite worktops. There is an integrated fridge, freezer, Miele oven, microwave and induction hob, and Neff dishwasher. The living/dining area is spacious and has two glass folding doors leading out onto the courtyard. There is also a utility room located off the kitchen with a washing machine. There is also a WC.

The bedroom is large and benefits from an en-suite bathroom. The bathroom has shower over bath, WC and sink. There is also a built in cupboard for storage, and an alcove ideal for a dressing area or home office space.

The property is available from the 18th July and would best suit a single/professional couple.

Council tax band D: £2325.27

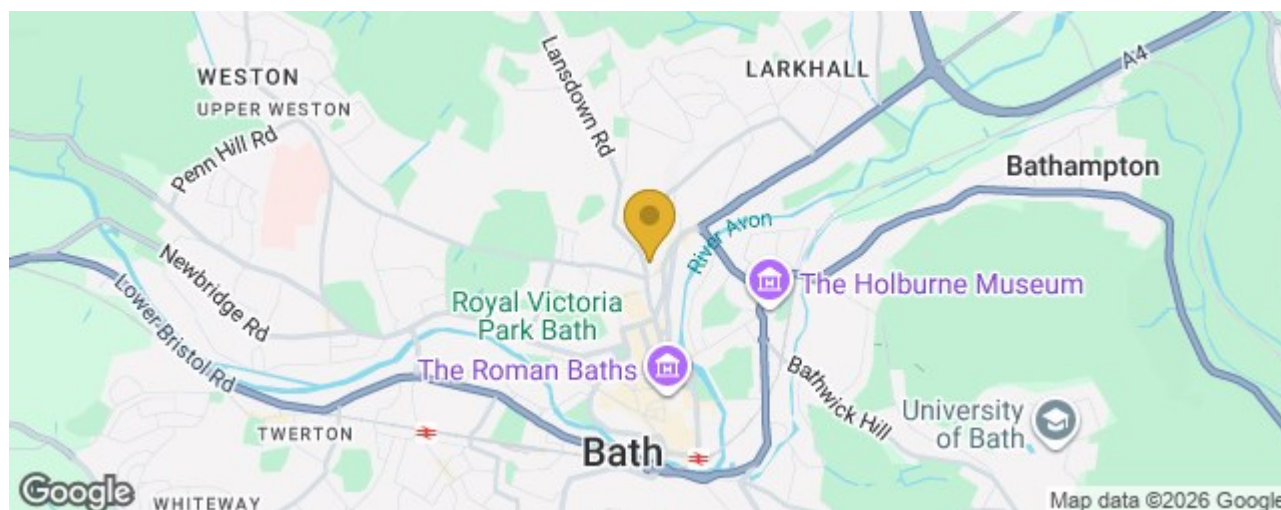



# Floor Plan

GROUND FLOOR  
826 sq.ft. (76.8 sq.m.) approx.

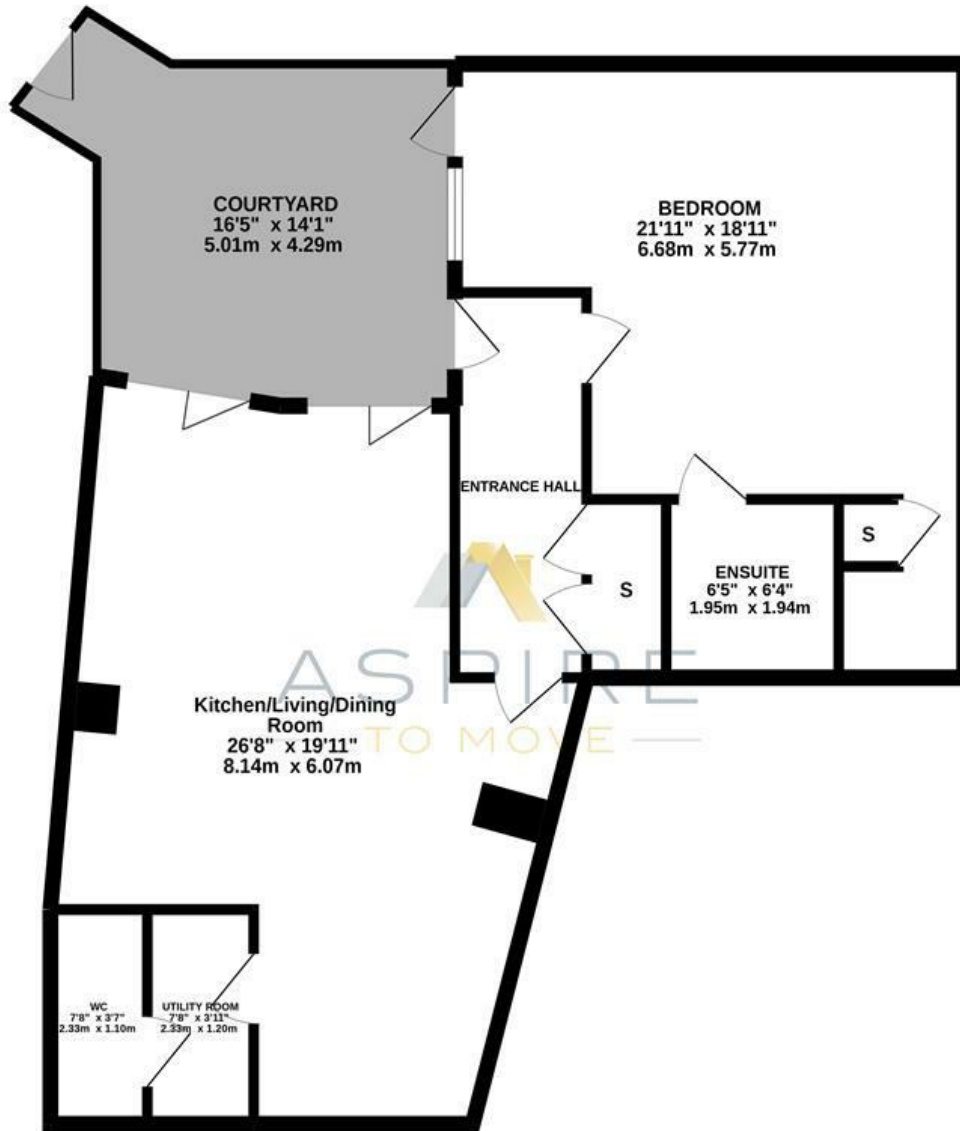

HOPE PLACE, BATH, BA1

TOTAL FLOOR AREA : 826 sq.ft. (76.8 sq.m.) approx.

Whilst every attempt has been made to ensure the accuracy of the floorplan contained here, measurements of doors, windows, rooms and any other items are approximate and no responsibility is taken for any error, omission or mis-statement. This plan is for illustrative purposes only and should be used as such by any prospective purchaser. The services, systems and appliances shown have not been tested and no guarantee as to their operability or efficiency can be given.  
Made with Metropix ©2022.

These particulars, whilst believed to be accurate are set out as a general outline only for guidance and do not constitute any part of an offer or contract. Intending purchasers should not rely on them as statements of representation of fact, but must satisfy themselves by inspection or otherwise as to their accuracy. No person in this firm's employment has the authority to make or give any representation or warranty in respect of the property.

